

Courses down Chartiers Cr.
 S. 5° W. 30. 8.
 S. 45. E. 20 8.
 S. 10. E. 17 8.
 S. 60. E. 55 8.
 N. 30. E. 300. 8.

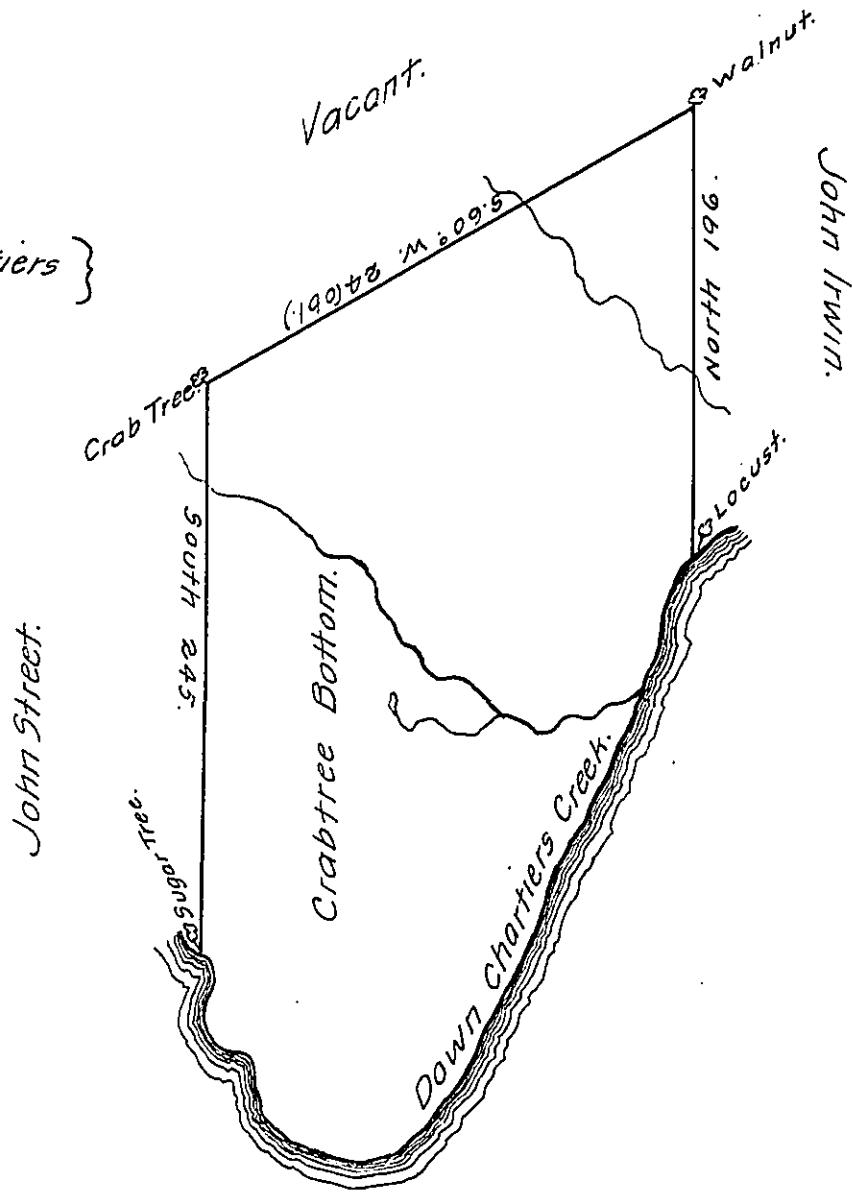

In pursuance of an order No 3128 dated 20th April, 1769 the above is a Draught of a Tract of land call'd Crabtree Bottom containing 370 Acres & the usual allowance of 6 1/2 C. for Roads &c. situated on the West side Monongahala survey'd 2d November, 1770 for Robert Innis.

To John Lukens, Esqr, } by James Hendricks, D.S.
 Surveyor General.

[Note Attached]

Robert Innis 370 Acres West side Monongahala -

1 Tract $\frac{230}{600}$ &c.

N.B. Applied for 2 Tracts of 300 Acres each. April 2d, 1771.

To John Lukens, Esq., Admit of above surveys

Surveyor General.

John Penn.

IN TESTIMONY that the above is a copy of the original remaining on file in the Department of Internal Affairs of Pennsylvania, made conformably to an Act of Assembly approved the 16th day of February, 1833, I have hereunto set my Hand and caused the Seal of said Department to be affixed at Harrisburg, this twenty seventh day of February 1911.

Henry Houck
 Secretary of Internal Affairs.